

Datablad innfellingshøytaler LBC 3086/41



LBC 3086/41 en 6 W innfellingshøytaler som er laget for innfelling. Den er godkjent for talevarsling etter EN 54-24 for høyttalere.

Høytteren har innebygd trafo og kan benyttes på 70V og 100V systemer. Den har fire tappinger 6-3-1,5-0,75 W.

Tekniske data:

Max effekt	9 W
Nominell effekt	6 W
Effektapping	6/3/1,5/0,75 W
Lydtrykk ved 10W/1W (1kHz, 1 m)	98/90 dB (SPL)
Frekvensområde	90 til 20kHz, 10 db
Åpningsvinkel ved 1 kHz / 4 kHz (6dB)	180/50
Merke spenning	100V
Motstand	1667 ohm
Tilkoblinger	3 pola skruterterminal
Mål diameter	216 mm
Montasjehull	196 mm
Taktykkelse	9-25mm
Vekt	1,3 kg
Farge	off white RAL 9010
Brukstemperatur	-25- + 55 grader
Fuktighet	inntil 95 %

Oktavbåndet

	125 Hz	250 Hz	500 Hz	1 kHz	2 kHz	4 kHz	8 kHz
SPL 1.1	92	90	85	90	96	98	92
SPL max.	100	98	93	98	104	106	100
Q-factor	4.8	4.4	2.5	3.7	8.3	20	21
Efficiency	0.42	0.29	0.16	0.34	0.6	0.4	0.1
H. angle	160	160	180	160	90	50	40
V. angle	160	160	180	160	90	50	40

Acoustical performance specified per octave

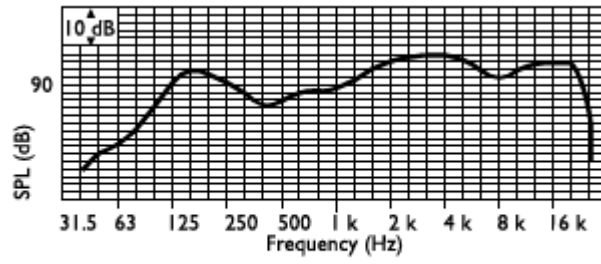

Frequency response

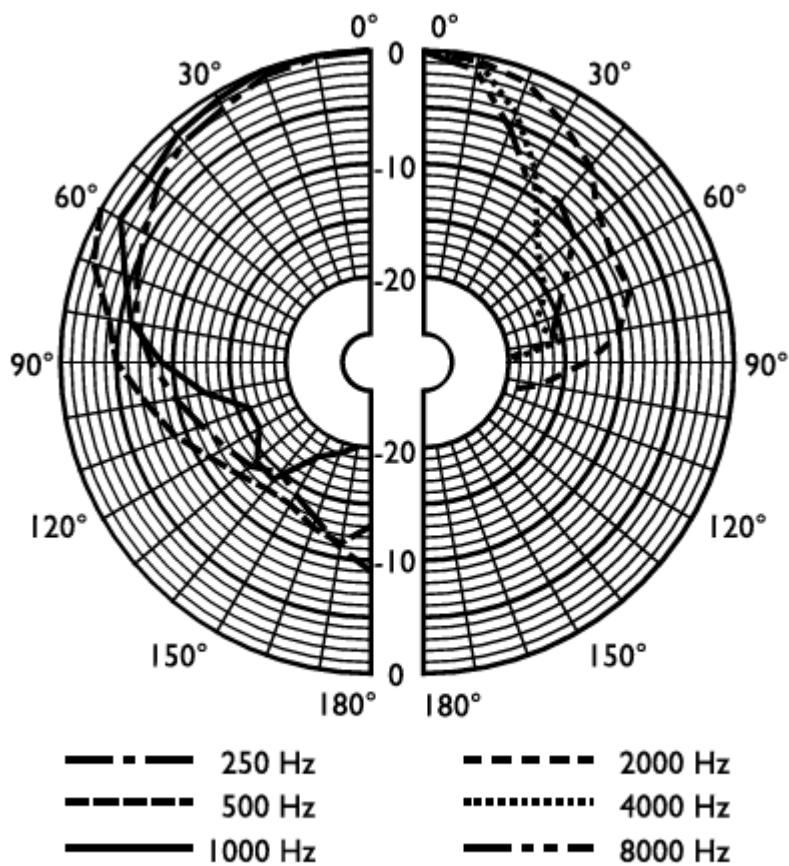

Polar diagram (measured with pink noise)

Tegninger:

1 Installation

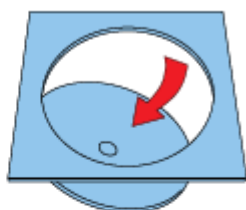

Figure 1.1

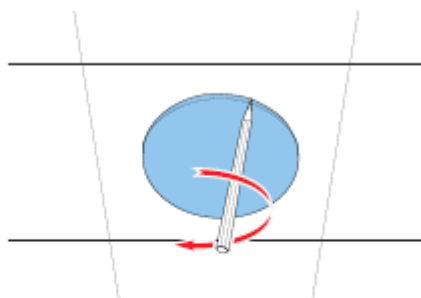

Figure 1.2

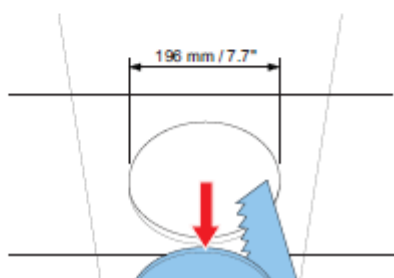

Figure 1.3

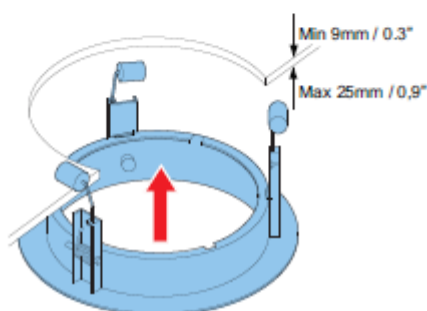

Figure 1.4

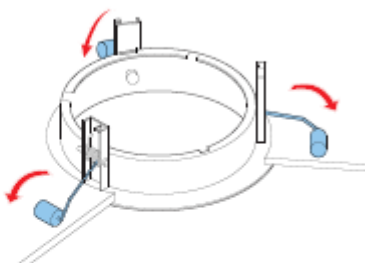

Figure 1.5

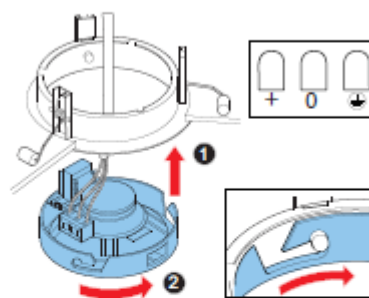

Figure 1.6



SECURITY & TECHNOLOGY